

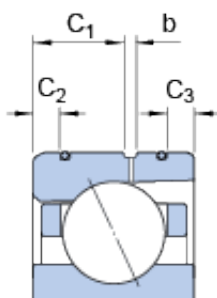

BEARING CORP.OF AMERICA

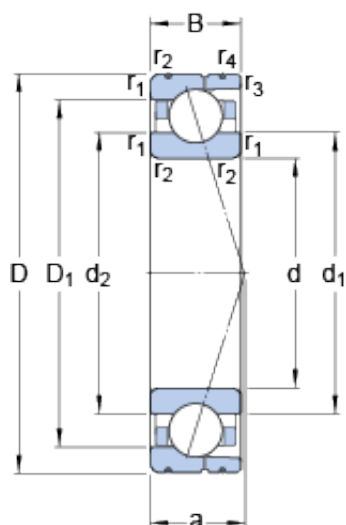

160 mm x 240 mm x 38 mm SKF 7032
ACD/P4AL Angular contact ball bearings

Bearing No. 7032 ACD/P4AL

7032 ACD/P4AL Bearing 2D drawings and 3D CAD models

| | |
|-------------------------|---------------|
| Size | 240x160x38 mm |
| Bore Diameter | 240 mm |
| Outer Diameter | 160 mm |
| Width | 38 mm |
| d | 160 mm |
| D | 240 mm |
| B | 38 mm |
| d ₁ | 184.7 mm |
| d ₂ | 184.7 mm |
| D ₁ | 215.3 mm |
| b | 2.8 mm |
| C ₁ | 21.2 mm |
| C ₂ | 7.1 mm |
| C ₃ | 6.6 mm |
| r _{1,2} - min. | 2.1 mm |
| r _{3,4} - min. | 1 mm |
| a | 65.9 mm |
| d _a - min. | 171 mm |
| d _b - min. | 171 mm |
| D _a - max. | 229 mm |
| D _b - max. | 235 mm |
| r _a - max. | 2 mm |
| r _b - max. | 1 mm |
| d _n | 191.4 mm |
| | |



BEARING CORP.OF AMERICA

| | |
|---|--------------------|
| Basic dynamic load rating - C | 182 kN |
| Basic static load rating - C ₀ | 204 kN |
| Fatigue load limit - P _u | 6.2 kN |
| Limiting speed for grease lubrication | 5000 r/min |
| Limiting speed for oil lubrication | 7500 mm/min |
| Ball - D _w | 25.4 mm |
| Ball - z | 22 |
| G _{ref} | 66 cm ³ |
| Calculation factor - e | 0.68 |
| Calculation factor - Y ₂ | 0.87 |
| Calculation factor - Y ₀ | 0.38 |
| Calculation factor - X ₂ | 0.41 |
| Calculation factor - Y ₁ | 0.92 |
| Calculation factor - Y ₂ | 1.41 |
| Calculation factor - Y ₀ | 0.76 |
| Calculation factor - X ₂ | 0.67 |
| Preload class A - G _A | 1150 N |
| Preload class B - G _B | 2300 N |
| Preload class C - G _C | 4600 N |
| Preload class D - G _D | 9200 N |
| Calculation factor - f | 1.16 |
| Calculation factor - f ₁ | 0.99 |
| Calculation factor - f _{2A} | 1 |
| Calculation factor - f _{2B} | 1.02 |
| Calculation factor - f _{2C} | 1.05 |
| Calculation factor - f _{2D} | 1.08 |
| Calculation factor - f _{HC} | 1 |



BEARING CORP.OF AMERICA

| | |
|--|--------------------|
| Preload class A | 414 N/micron |
| Preload class B | 540 N/micron |
| Preload class C | 717 N/micron |
| Preload class D | 968 N/micron |
| d_1 | 184.7 mm |
| d_2 | 184.7 mm |
| D_1 | 215.3 mm |
| C_1 | 21.2 mm |
| C_2 | 7.1 mm |
| C_3 | 6.6 mm |
| $r_{1,2}$ min. | 2.1 mm |
| $r_{3,4}$ min. | 1 mm |
| d_a min. | 171 mm |
| d_b min. | 171 mm |
| D_a max. | 229 mm |
| D_b max. | 235 mm |
| r_a max. | 2 mm |
| r_b max. | 1 mm |
| d_n | 191.4 mm |
| Basic dynamic load rating C | 182 kN |
| Basic static load rating C_0 | 204 kN |
| Fatigue load limit P_u | 6.2 kN |
| Attainable speed for grease lubrication | 5000 r/min |
| Attainable speed for oil-air lubrication | 7500 r/min |
| Ball diameter D_w | 25.4 mm |
| Number of balls z | 22 |
| Reference grease quantity G_{ref} | 66 cm ³ |
| Preload class A G_A | 1150 N |
| Static axial stiffness, preload class A | 414 N/ μ m |
| | |



BEARING CORP.OF AMERICA

| | |
|---|----------------|
| Preload class B G_B | 2300 N |
| Static axial stiffness, preload class B | 540 N/ μ m |
| Preload class C G_C | 4600 N |
| Static axial stiffness, preload class C | 717 N/ μ m |
| Preload class D G_D | 9200 N |
| Static axial stiffness, preload class D | 968 N/ μ m |
| Calculation factor f | 1.16 |
| Calculation factor f_1 | 0.99 |
| Calculation factor f_{2A} | 1 |
| Calculation factor f_{2B} | 1.02 |
| Calculation factor f_{2C} | 1.05 |
| Calculation factor f_{2D} | 1.08 |
| Calculation factor f_{HC} | 1 |
| Calculation factor e | 0.68 |
| Calculation factor (single, tandem) Y_2 | 0.87 |
| Calculation factor (single, tandem) Y_0 | 0.38 |
| Calculation factor (single, tandem) X_2 | 0.41 |
| Calculation factor (back-to-back, face-to-face) Y_1 | 0.92 |
| Calculation factor (back-to-back, face-to-face) Y_2 | 1.41 |
| Calculation factor (back-to-back, face-to-face) Y_0 | 0.76 |
| Calculation factor (back-to-back, face-to-face) X_2 | 0.67 |
| Mass bearing | 5.15 kg |