

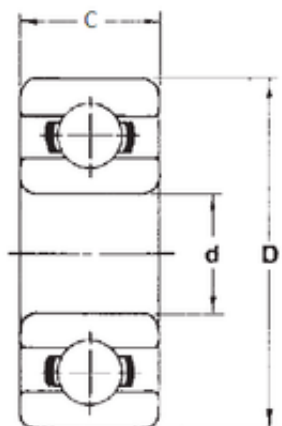

BEARING CORP.OF AMERICA



2,38 mm x 7,938 mm x 2,779 mm FBJ R1-5
Deep groove ball bearings

Bearing No. R1-5

Size	2.38x7.938x2.779 mm
Bore Diameter	2,38 mm
Outer Diameter	7,938 mm
Width	2,779 mm
d	2,38 mm
D	7,938 mm
B	2,779 mm
C	2,779 mm
Weight	0,0006 Kg
Basic dynamic load rating (C)	0,549 kN
Basic static load rating (C0)	0,177 kN
(Grease) Lubrication Speed	60000 r/min

R1-5 Bearing 2D drawings and 3D CAD models