

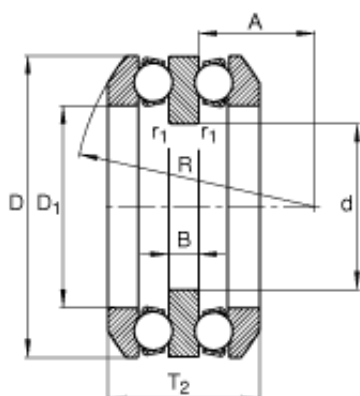

BEARING CORP.OF AMERICA



50 mm x 95 mm x 10 mm FAG 54212 Thrust ball bearings

Bearing No. 54212

Size	50x95x50 mm
Bore Diameter	50 mm
Outer Diameter	95 mm
Width	50 mm
d	50 mm
D	95 mm
T ₂	50 mm
A	30,5 mm
B	10 mm
D ₁	62 mm
D _{a max}	78 mm
d _{a max}	60 mm
R	72 mm
r _{1 min}	0,6 mm
r _{a max}	1 mm
r _{a1 max}	0,6 mm
r _{min}	1 mm
m	1,17 kg / Weight
C _a	62000 N / Dynamic load rating (axial)
C _{0a}	140000 N / Static load rating (axial)
A	0,12 / Factor min. load
n _G	4200 1/min / Limiting speed
C _{ua}	6200 N / Fatigue limit load,

54212 Bearing 2D drawings and 3D CAD models



BEARING CORP.OF AMERICA

	axial
--	-------